

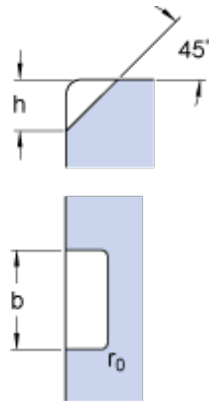

BEARING USA CORP.

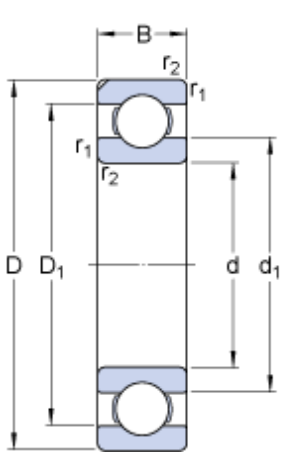

670 mm x 980 mm x 136 mm SKF 60/670
N1MAS deep groove ball bearings

Bearing No. 60/670 N1MAS

60/670 N1MAS Bearing 2D drawings and 3D CAD models

Size	980x670x136 mm
Bore Diameter	980 mm
Outer Diameter	670 mm
Width	136 mm
d	670 mm
D	980 mm
B	136 mm
d ₁	771.82 mm
D ₁	877.52 mm
h	32 mm
b	20.5 mm
r _{1,2} - min.	7.5 mm
r ₀	3 mm
d _a - min.	698 mm
D _a - max.	952 mm
r _a - max.	6 mm
Basic dynamic load rating - C	904 kN
Basic static load rating - C ₀	2040 kN
Fatigue load limit - P _u	30 kN
Reference speed	1100 r/min
Limiting speed	900 r/min
Calculation factor - k _r	0.025
Calculation factor - f ₀	16.2
d ₁	772 mm



BEARING USA CORP.

D_1	877.52 mm
r_0	3 mm
$r_{1,2}$ min.	7.5 mm
d_a min.	698 mm
D_a max.	952 mm
r_a max.	6 mm
Basic dynamic load rating C	904 kN
Basic static load rating C_0	2040 kN
Fatigue load limit P_u	30 kN
Calculation factor k_r	0.025
Calculation factor f_0	16.2
Mass bearing	345 kg