

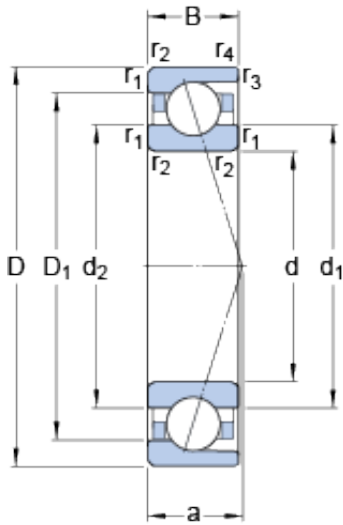

BEARING USA CORP.

110 mm x 150 mm x 20 mm SKF 71922 CD/HCP4A angular contact ball bearings

Bearing No. 71922 CD/HCP4A



71922 CD/HCP4A Bearing 2D drawings and 3D CAD models

Size	150x110x20 mm
Bore Diameter	150 mm
Outer Diameter	110 mm
Width	20 mm
d	110 mm
D	150 mm
B	20 mm
d ₁	122.3 mm
d ₂	122.3 mm
D ₁	137.7 mm
r _{1,2} - min.	1.1 mm
r _{3,4} - min.	0.6 mm
a	27.5 mm
d _a - min.	116 mm
d _b - min.	116 mm
D _a - max.	144 mm
D _b - max.	146 mm
r _a - max.	1 mm
r _b - max.	0.6 mm
d _n	125.6 mm
Basic dynamic load rating - C	62.4 kN
Basic static load rating - C ₀	72 kN
Fatigue load limit - P _u	2.7 kN
Limiting speed for grease	10000 r/min



BEARING USA CORP.

Lubrication	
Limiting speed for oil lubrication	16000 mm/min
Ball - D_w	12.7 mm
Ball - z	28
G_{ref}	11.4 cm ³
Calculation factor - f_0	16.5
Preload class A - G_A	230 N
Preload class B - G_B	460 N
Preload class C - G_C	920 N
Preload class D - G_D	1840 N
Calculation factor - f	1.26
Calculation factor - f	1
Calculation factor - f_{2A}	1
Calculation factor - f_{2B}	1.07
Calculation factor - f_{2C}	1.12
Calculation factor - f_{2D}	1.18
Calculation factor - f_{HC}	1.04
Preload class A	126 N/micron
Preload class B	173 N/micron
Preload class C	245 N/micron
Preload class D	361 N/micron
d_1	122.3 mm
d_2	122.3 mm
D_1	137.7 mm
$r_{1,2}$ min.	1.1 mm
$r_{3,4}$ min.	0.6 mm
d_a min.	116 mm
d_b min.	116 mm
D_a max.	144 mm



BEARING USA CORP.

D_b max.	146 mm
r_a max.	1 mm
r_b max.	0.6 mm
d_n	125.6 mm
Basic dynamic load rating C	62.4 kN
Basic static load rating C_0	72 kN
Fatigue load limit P_u	2.7 kN
Attainable speed for grease lubrication	10000 r/min
Attainable speed for oil-air lubrication	16000 r/min
Ball diameter D_w	12.7 mm
Number of balls z	28
Reference grease quantity G_{ref}	11.4 cm ³
Preload class A G_A	230 N
Static axial stiffness, preload class A	126 N/ μ m
Preload class B G_B	460 N
Static axial stiffness, preload class B	173 N/ μ m
Preload class C G_C	920 N
Static axial stiffness, preload class C	245 N/ μ m
Preload class D G_D	1840 N
Static axial stiffness, preload class D	361 N/ μ m
Calculation factor f	1.26
Calculation factor f_1	1
Calculation factor f_{2A}	1
Calculation factor f_{2B}	1.07
Calculation factor f_{2C}	1.12
Calculation factor f_{2D}	1.18
Calculation factor f_{HC}	1.04



BEARING USA CORP.

Calculation factor f_0	16.5
Mass bearing	0.73 kg