

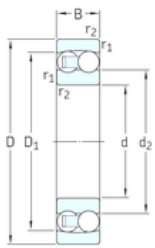

BEARING USA CORP.



Cylindrical bore



Tapered bore

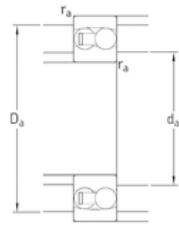

30 mm x 72 mm x 19 mm SKF 1306EKTN9 self aligning ball bearings

Bearing No. 1306EKTN9

1306EKTN9 Bearing 2D drawings and 3D CAD models

Size	30x72x19 mm
Bore Diameter	30 mm
Outer Diameter	72 mm
Width	19 mm
d	30 mm
D	72 mm
B	19 mm
C	19 mm
d2	44,9 mm
r1 min.	1,1 mm
r2 min.	1,1 mm
D1	60,9 mm
da min.	37 mm
Da max.	65 mm
ra max.	1,1 mm
Weight	0,39 Kg
Basic dynamic load rating (C)	22,5 kN
Basic static load rating (C0)	6,8 kN
Fatigue load limit (Pu)	0,36
Reference speed	19000 r/min
Limiting speed	13000 r/min
Calculation factor (e)	0,25
Calculation factor (kr)	0,04
Calculation factor (Y0)	2,5
Calculation factor (Y1)	2,5



BEARING USA CORP.