

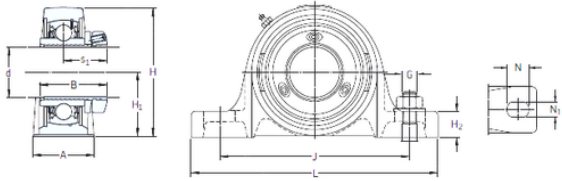

BEARING USA CORP.

SKF SY 30 PF bearing units



Bearing No. SY 30 PF

Bore Diameter	30 mm
Width	45 mm
d	30 mm
s1	31 mm
A	40 mm
B	45 mm
G	12 mm
H	82 mm
H1	42,9 mm
H2	17 mm
J	117,5 mm
L	152 mm
N	23,5 mm
N1	14 mm
Weight	1,2 Kg
Basic dynamic load rating (C)	19,5 kN
Basic static load rating (C0)	11,2 kN

SY 30 PF Bearing 2D drawings and 3D CAD models