

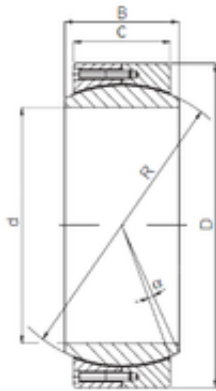

BEARING USA CORP.

340 mm x 460 mm x 160 mm ISO GE340DW
plain bearings



Bearing No. GE340DW

Size	340x460x160 mm
Bore Diameter	340 mm
Outer Diameter	460 mm
Width	160 mm
d	340 mm
D	460 mm
B	160 mm
C	135 mm
R	400 mm
Angle	3,8 °

GE340DW Bearing 2D drawings and 3D CAD models