

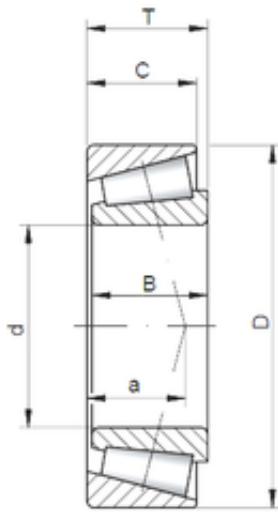

## BEARING USA CORP.



66,675 mm x 112,712 mm x 30,162 mm ISO  
39590/39521 tapered roller bearings

Bearing No. 39590/39521

Size	66.675x112.712x30.162 mm
Bore Diameter	66,675 mm
Outer Diameter	112,712 mm
Width	30,162 mm
d	66,675 mm
D	112,712 mm
T	30,162 mm
B	30,162 mm
C	23,812 mm
a	6,6 mm

39590/39521 Bearing 2D drawings and 3D CAD models