

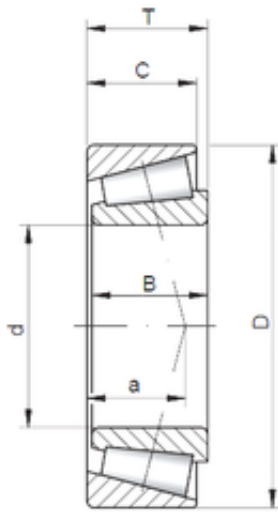

BEARING USA CORP.



22,606 mm x 47 mm x 15,5 mm ISO
LM72849/10 tapered roller bearings

Bearing No. LM72849/10

Size	22.606x47x15.5 mm
Bore Diameter	22,606 mm
Outer Diameter	47 mm
Width	15,5 mm
d	22,606 mm
D	47 mm
T	15,5 mm
B	15,5 mm
C	12 mm
a	3 mm

LM72849/10 Bearing 2D drawings and 3D CAD models