

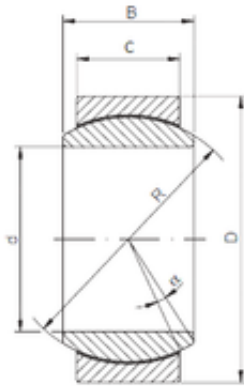

BEARING USA CORP.

45 mm x 68 mm x 32 mm ISO GE 045 ECR-2RS
plain bearings



Bearing No. GE 045 ECR-2RS

Size	45x68x32 mm
Bore Diameter	45 mm
Outer Diameter	68 mm
Width	32 mm
d	45 mm
D	68 mm
B	32 mm
C	25 mm
R	60 mm
Angle	7 °

GE 045 ECR-2RS Bearing 2D drawings and 3D CAD models