

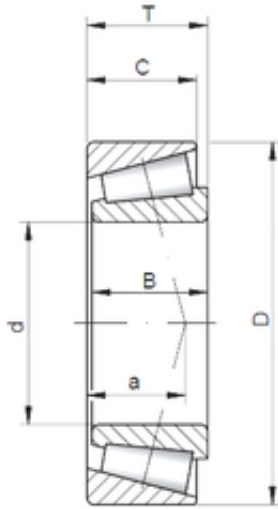

BEARING USA CORP.



55 mm x 110 mm x 35 mm ISO T2ED055
tapered roller bearings

Bearing No. T2ED055

Size	55x110x39 mm
Bore Diameter	55 mm
Outer Diameter	110 mm
Width	39 mm
d	55 mm
D	110 mm
T	39 mm
B	35 mm
C	27 mm
a	25 mm

T2ED055 Bearing 2D drawings and 3D CAD models